

PRODUCT CATALOG

English



MAZU.



TABLE OF CONTENT

This is MAZU	Page 3
Ambient planters & accessories	Page 4 - 10
Custom projects	Page 11 - 13
Technical information	Page 14- 16
Contact	Page 17

THIS IS MAZU



At MAZU, we are redefining pottery by blending advanced craftsmanship, premium materials, and innovative integrated lighting.

Our creations do more than decorate, they transform your indoor and outdoor living and working spaces with both style and illumination.

Our in-house team creates a unique collection of planters that combine sophisticated design with high-end LED lighting, seamlessly integrated around the top rim to elegantly illuminate your tree or plant. These innovative planters are crafted from premium recycled aluminium and are available in four distinctive designs, each offered in various sizes.

Not only do these planters elevate the beauty of your greenery, they also provide functional lighting, making them a captivating focal point for any indoor or outdoor setting. The true essence of this concept lies in its seamless fusion of horticulture and technology, delivering both aesthetic appeal and practical functionality in a single elegant solution.

Transform your spaces - indoors or outdoors - into brighter, greener, and more enchanting environments with MAZU planters.

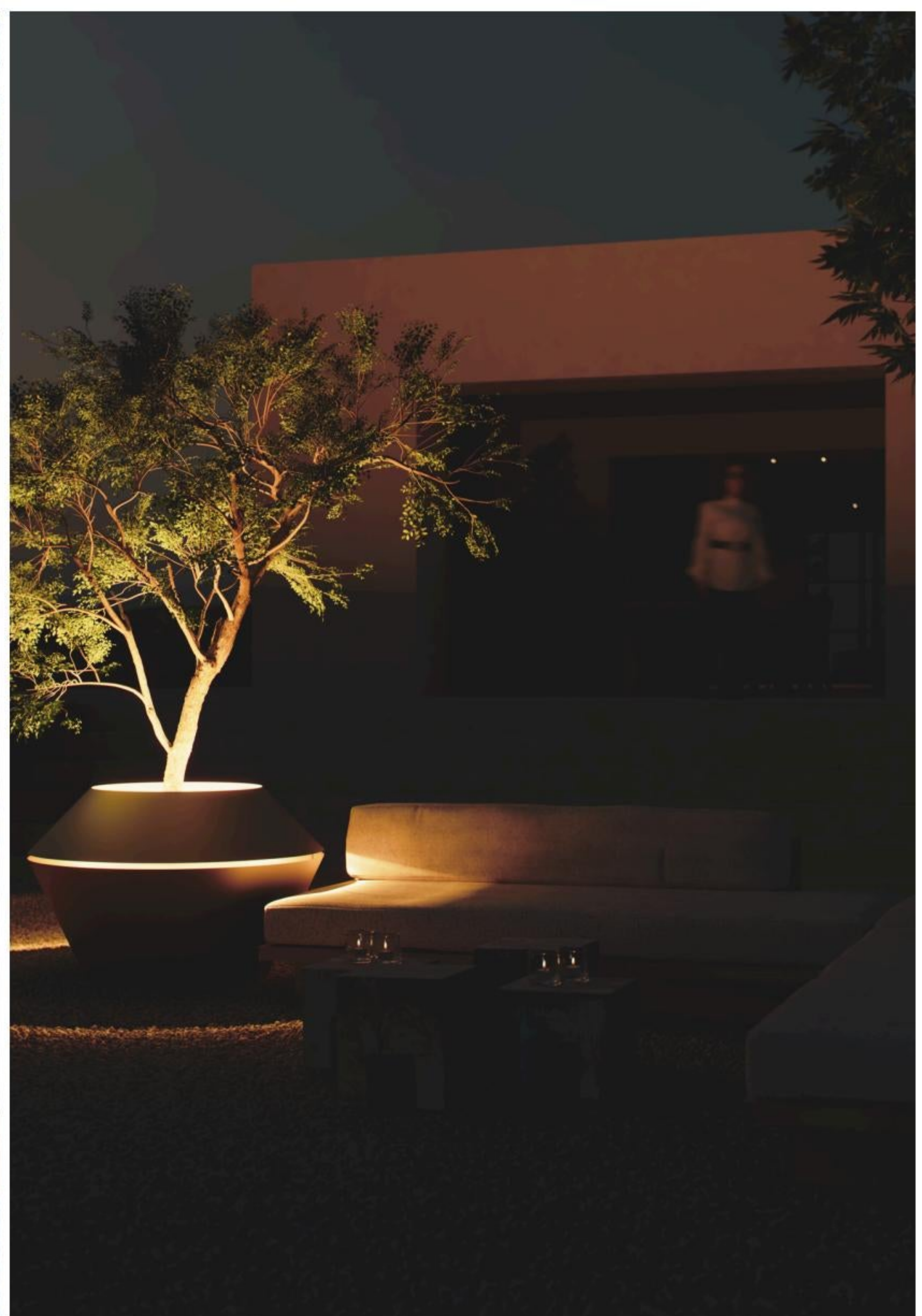
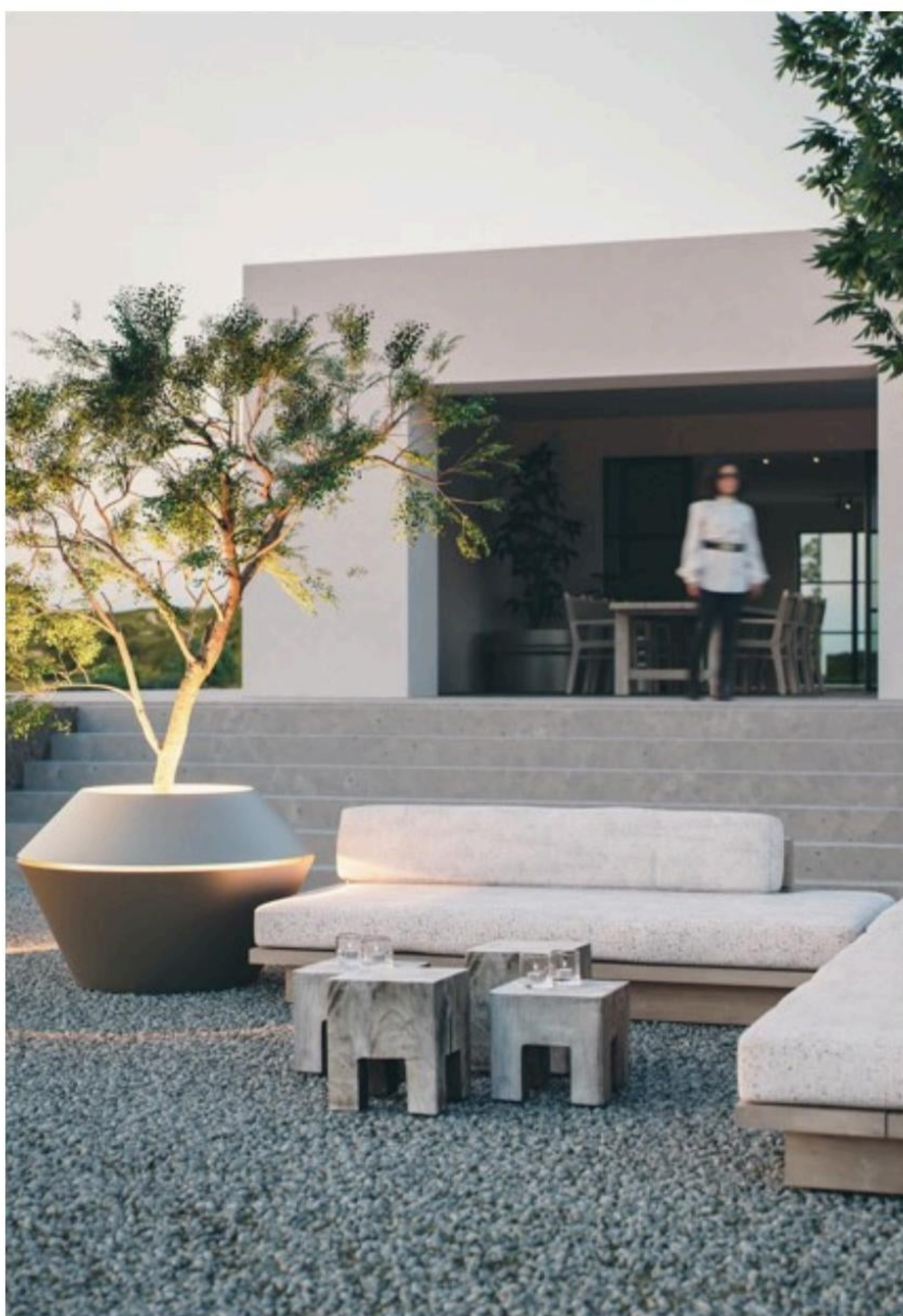

AMBIENT PLANTERS



COLLECTION **TANK**

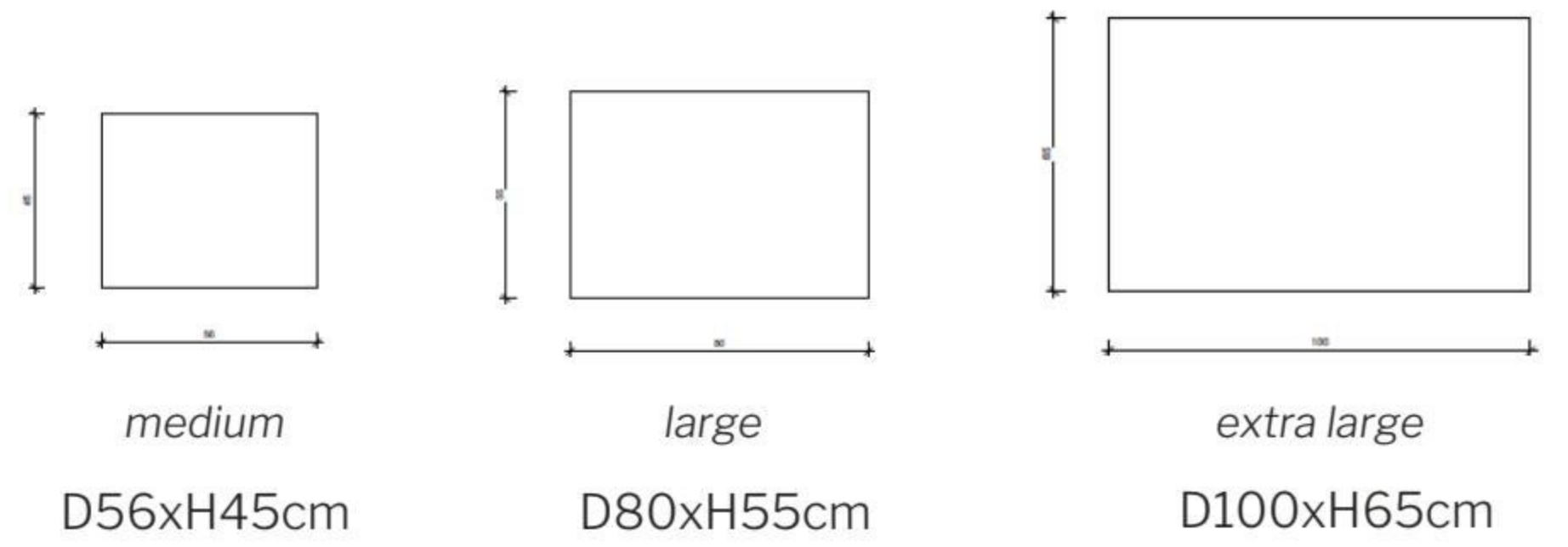

Available Colors:



COLLECTION **WEDGE**

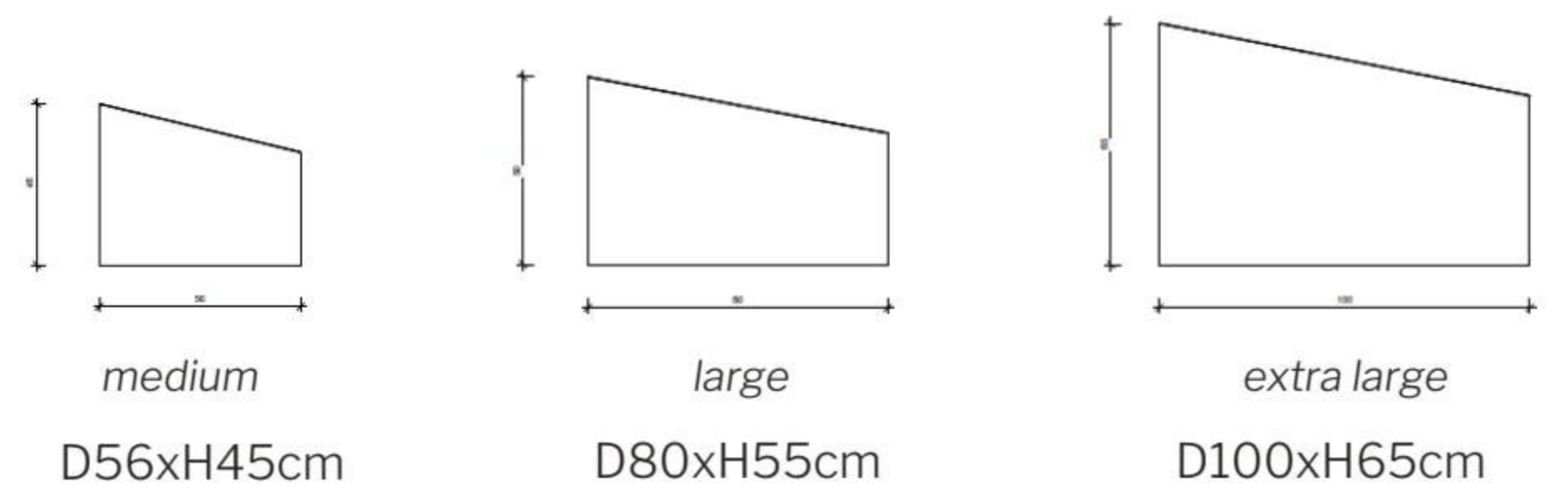

Available Colors:



For indoor & outdoor use
Recycled aluminium | EU
Powdura Powder Coating | marine grade
Hardwired dimmable LED line | 2700K LED
Dimmable driver 5 in 1 | IP67



Tank, Santorini



COLLECTION NAUTILUS

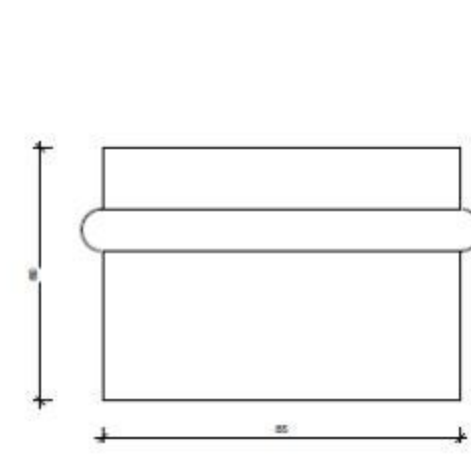

large

D80xH55cm

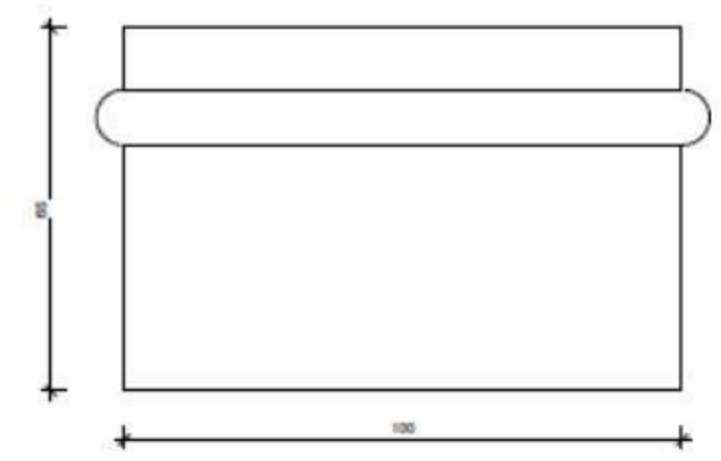

extra large

D100xH65cm

Available Colors:



Bl/Brown C34



Bronze C33



Light Grey C31



Ivory 1013 HR



COLLECTION OYSTER

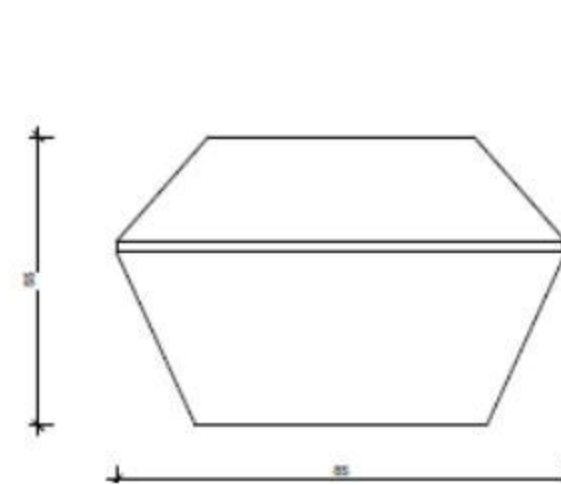

medium

D85xH55cm

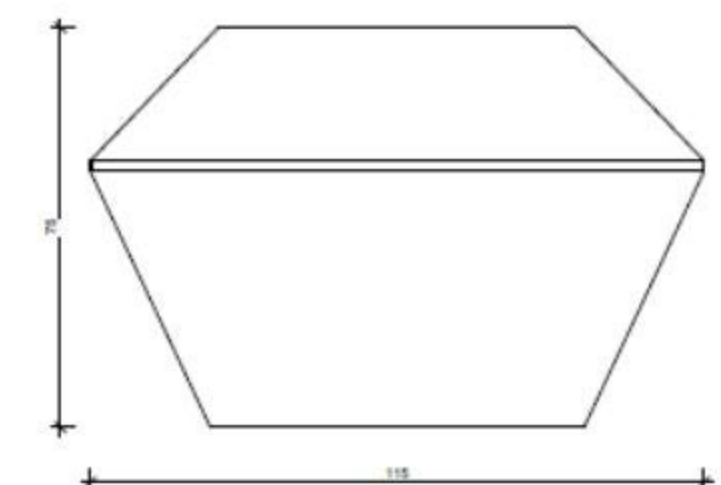

large

D115xH75cm

Available Colors:



Bl/Brown C34



Bronze C33



Light Grey C31



Ivory 1013 HR

For indoor & outdoor use
Recycled aluminium | EU
Powdura Powder Coating | marine grade
Hardwired dimmable LED line | 2700K LED
Dimmable driver 5 in 1 | IP67



Wedge, Moraira

Every MAZU planter includes a 9 cm clearance, making it fully compatible with our custom MAZU wheels. Wheels can be added to the large and extra large models, offering flexibility and ease of movement.

To protect your plants in extreme temperatures - above 40°C or below -10°C - each planter comes with a complimentary 3 cm high-performance outdoor foam insert. This insulation layer sits at the bottom of the planter, helping to shield roots from intense heat or deep frost with no extra effort.

All MAZU planters are designed to work seamlessly with standard irrigation systems, ensuring consistent hydration without the need for daily watering or guesswork. A simple, smart solution for thriving plants in any season.



AMBIENT ACCESSORIES



At our planter company, we have the resources and expertise to create custom projects tailored to individual needs. Whether you envision a unique design for your garden, terrace, or indoor space, we can bring your ideas to life with our bespoke designs and exceptional craftsmanship.

Let us help you craft a personalized, stunning focal point that perfectly complements your style and enhances any environment, indoors or outdoors. With MAZU, your space will exude elegance and individuality.

Contact us today for a quote and let us turn your vision into reality,
info@thisismazu.com.

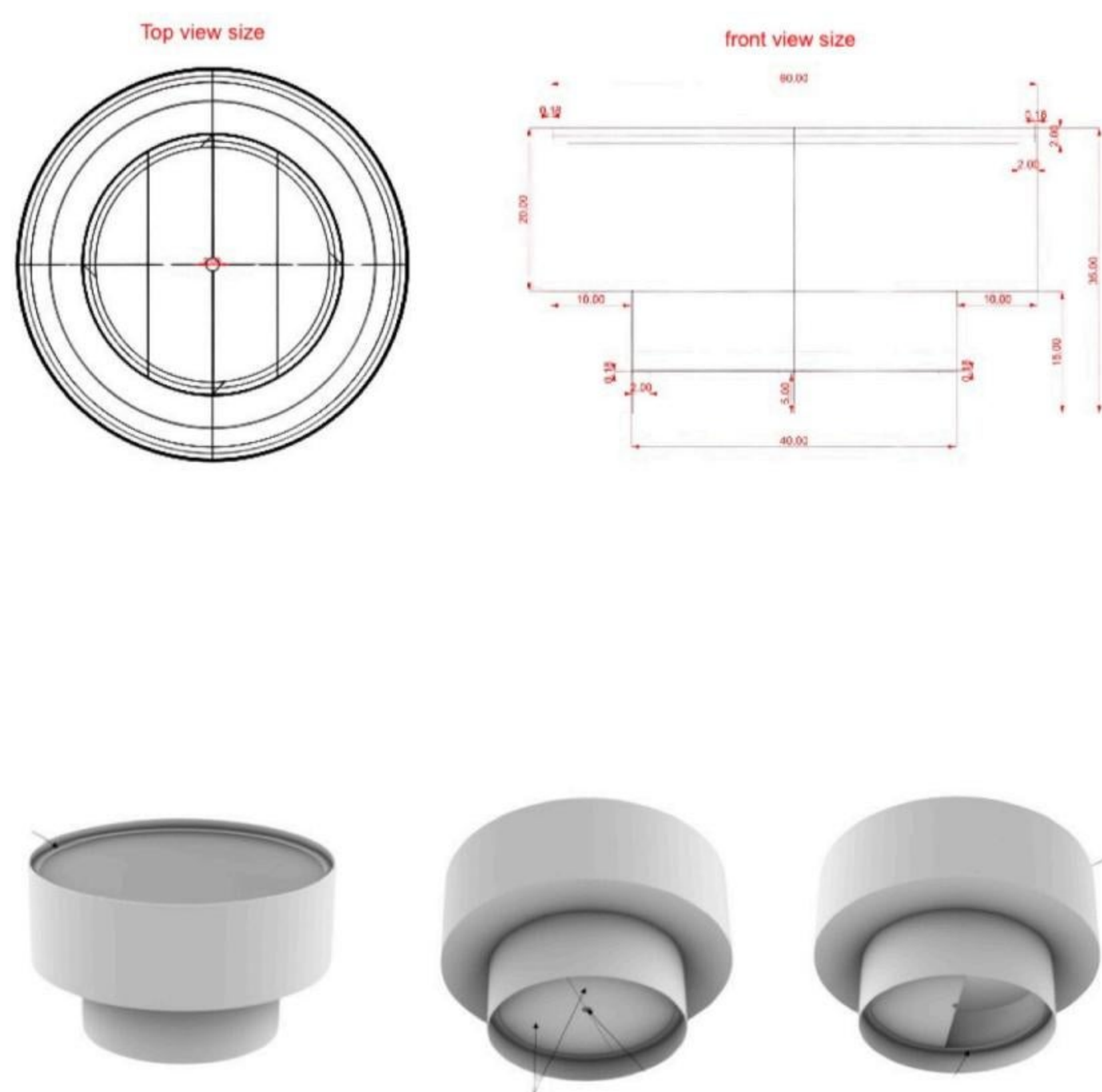

CUSTOM PROJECTS



We offer in-house design expertise, working closely with you to bring your vision to life. Let's create something great together.

We bring in-house design expertise to every project, working closely with you to turn ideas into meaningful, refined outcomes. Whether you're starting with a clear concept or looking for creative direction, our team helps bring your vision to life with precision and care. From start to finish, we offer seamless A-to-Z solutions through our strong network of trusted partners.

Every product is assembled in collaboration with a social atelier, supporting local employment and social inclusion. We're committed to sustainability—not just in the materials we use, but in the way we work. Quality is never compromised: every detail is carefully controlled to ensure lasting durability and a high-end finish.

Beyond design, we specialize in combining light with other materials to create innovative, multi-purpose solutions that are both responsible and inspiring.



Tank, Ibiza

TECHNICAL INFORMATION



Technical Specifications for outdoor **LED luminaire**

High efficiency: Top bend led neon light, with specifications 140LED/m, 14.4W/m, DC24V; 2700K, CRI>85; 50mm/unit, beam angle 270°.

Weatherproof: Rated IP65 for protection against dust and water ingress.

Long lifespan: Provides over 50,000 hours of operation, reducing maintenance costs and 5 year warranty.

Wide operating temperature range: functions effectively between -40°C to +50°C.

Hardwired dimmable LED line and wireless via bluetooth or wifi

Dimmable driver 5 in 1 rated IP67: input voltage of 100-240V at 50/60Hz, delivering a 24V output voltage with a maximum output current of 6.25A.

TECHNICAL INFORMATION



We use premium European recycled aluminium known for its superior quality, ensuring durability and a sleek finish. The aluminium is coated with eco-friendly powder from Sherwin-Williams, offering both an environmentally conscious solution and a high-performance, long-lasting finish for our decorative projects.

Powdura is a specific line of powder coatings developed by Sherwin-Williams, designed to meet diverse industrial and commercial applications. While powder coating in general refers to a finishing process that involves applying a dry, electrostatically charged powder to a surface and curing it with heat, Powdura stands out due to several unique features and benefits:

- Enhanced Durability
- Sustainability
- Innovative Technologies

While generic powder coatings may suffice for standard needs, Powdura offers specialized options and ensures consistency, longevity, and compliance with industry-specific requirements.

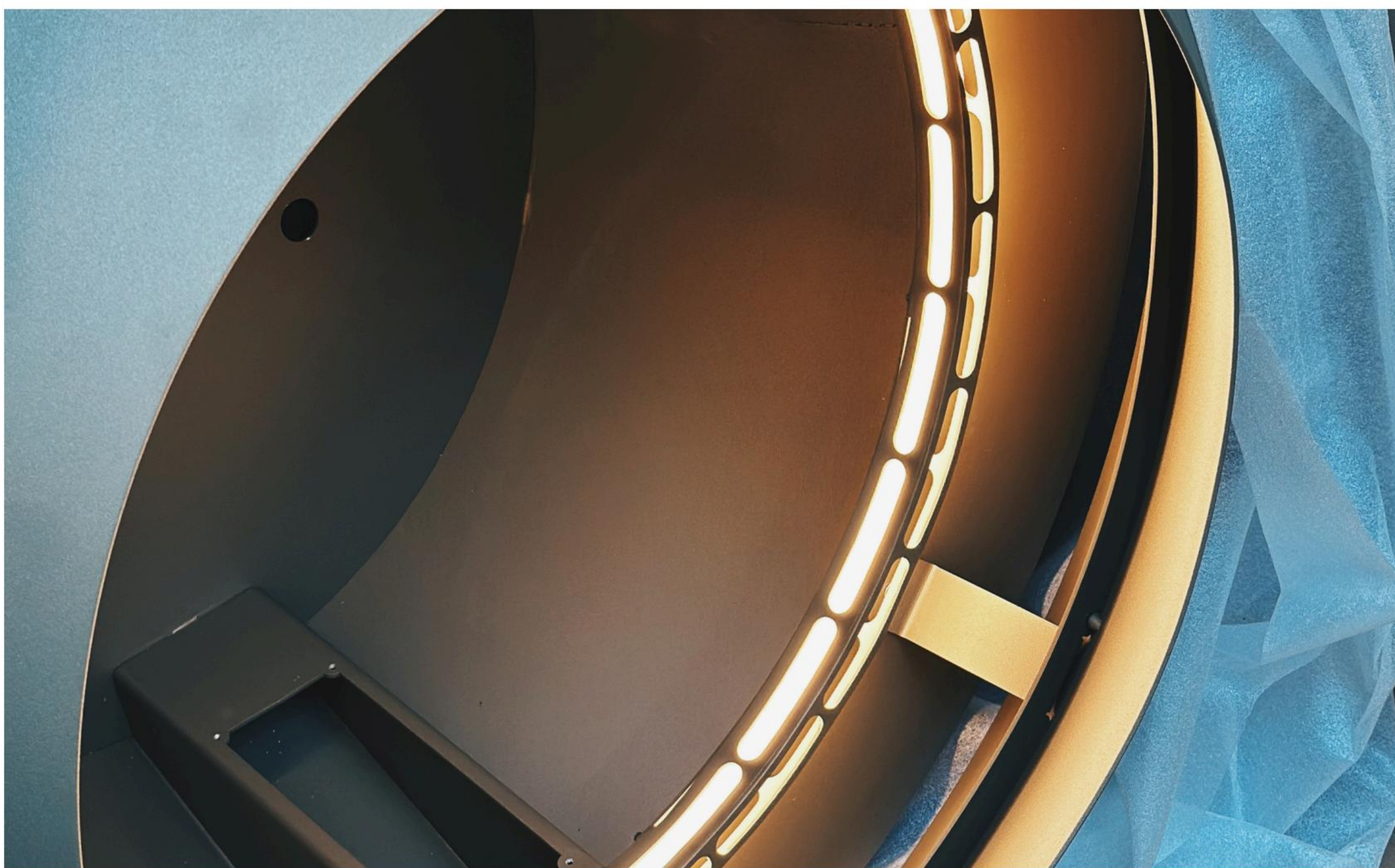

CONTACT US

Feel free to contact us:
info@thisismazu.com
www.thisismazu.com

